



## MEETINGS AND CONFERENCES AT LOUGH ESKE CASTLE

Lough Eske Castle, located just outside Donegal Town has a rich history being associated with the O'Donnells, the founding fathers of Donegal, a county in the northwest region of Ireland. This is an historic building in a storybook location delivering superior hospitality and comfort. It is the ideal place for the business traveller who wants modern day comforts and solitude to brainstorm; the wedding couple who want a wow venue for their special day or the company who wants something different for their clients and employees. It is the only Irish property to claim a World Luxury Hotel Award and has won the Luxury Country Hotel title two years in a row

Lough Eske Castle, a Solis Hotel & Spa. *Where life takes you.*



LOUGH  
**eske**

CASTLE

HOTEL & SPA

A SOLIS™ HOTEL

[www.solislougheskecastle.ie](http://www.solislougheskecastle.ie)



## Lough Eske Castle

comprises 96 luxurious guestrooms including a two bedroom presidential suite, Cedars Grill Restaurant, the Gallery Bar and Lobby Lounge and the Oak Bar, 6,500 sq. ft. of conference and banqueting space and Spa Solis which includes a thermal suite, a relaxation area, a 17m swimming pool and fitness centre.

### LOCATION AND TRANSPORT

- Located just 5km from Donegal Town within 43 acres of forest woodland hugging the shores of Lough Eske with the Blue Stack Mountains in the background.
- 60km from Sligo Airport and 85km from City of Derry Airport, both of which are approximately 1 hrs drive.
- 180km from Belfast International Airport, within 2½ hrs drive.
- 220km from Dublin International Airport, approximately 3½ hrs drive.
- Knock (135km), Galway (200km) and Shannon (275km) airports are located within 2 hrs, 3 hrs and 4 hrs drive respectively.
- Valet parking to spacious and secure car park.
- Car Hire, and Chauffeur Drive Car Service available upon request.

Lough Eske Castle, a Solis Hotel & Spa.  
*Where life takes you.*

### SPA SOLIS AT LOUGH ESKE CASTLE

- Situated on the footprint of the original glasshouse of the old castle.
- Uses Aromatherapy Associates unique product range to promote the healing powers of natural plant extracts.
- 8 treatment rooms including 2 couples suites with jet bath and steam room.
- A thermal suite comprising an ice fountain, sauna, steam room, sanarium, tropical experience showers, heated bench and an infinity pool.
- A relaxation area facing onto the gardens.
- Specialist consultation services are available.
- 17m indoor heated swimming pool.
- Fully equipped state-of-the-art fitness centre.



## THE GREAT OUTDOORS

The area surrounding the castle is nestled between Donegal Bay and the famous Blue Stack Mountains, home to some of the finest hiking, mountain biking and surfing in all of Ireland. Guests at Lough Eske Castle enjoy easy, close access to golf, fishing, horseback riding and the charms of village life. The unspoiled countryside, combined with the wide array of outdoor activities makes Donegal a premier destination for events, team building and incentive groups.



- HIKING AND BIKING** Trails and tours wind through the Blue Stack Mountains (8 mins drive)
- WORLD CLASS GOLF** Four championship links golf courses (from 10 mins to 1½ hrs drive)
- PRISTINE BEACHES** Beautiful sandy beaches with Blue Flag status (from 20 mins to 2 hrs drive)
- WATERSPORTS** South Donegal coastline has some of Ireland's best surfing (20 mins drive)
- HORSEBACK RIDING** Lake-side and beach side riding excursions for experienced riders (30 mins drive)
- SUPERB FISHING** Unspoiled lake and river angling as well as saltwater fishing (from 5 mins walk to 30 mins drive)
- COASTAL SAILING** Boating tours and sailing excursions (from 5 mins drive to 1 hr 15 mins drive)
- SCUBA DIVING** Boat and shore diving day trips (30 mins drive)
- DONEGAL TOWN** Quaint country town with traditional Irish pubs and shops (5 mins drive)
- DAY TRIPS** Seaside cliffs, gardens, waterfalls, mountains as well as magnificent castles, ruins and other historic sites nearby (from 5 mins to 1 hrs drive)

## GUESTROOMS

The hotel sleeps 96 guests on single occupancy and 192 with double/twin occupancy. When hosting a large group event at the Castle, we work in partnership with our neighbouring hotel which is a 4 star property located within a 5 minute drive of the Castle.

- 96 luxuriously appointed guestrooms including a 2 bedroom presidential suite, 7 garden suites, 14 courtyard guestrooms, 8 Solis junior suites and 65 deluxe guestrooms.
- All rooms have WiFi access, flat screen televisions, a study desk with high speed internet access, voicemail, cedar closets with in-room safe, personal bar, complimentary mineral water and hospitality tray, individually controlled heat and 24 hour room service.
- Bathrooms have marble tiling throughout with double basin granite vanity units, a built in bath and separate glazed shower and toilet compartments.
- Luxury robes and slippers are provided as standard.



### PRESIDENTIAL SUITE

### GARDEN SUITES (7)

### SOLIS JUNIOR SUITES (8)

### DELUXE ROOMS (65)

### COURTYARD GUESTROOMS (14)



181 sq.m. | 2,000 sq.ft.



84-91 sq.m. | 90-1,000 sq.ft.



65 sq.m. | 700 sq.ft.

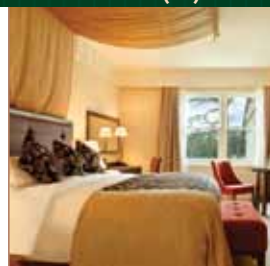

46 sq.m. | 500 sq.ft.

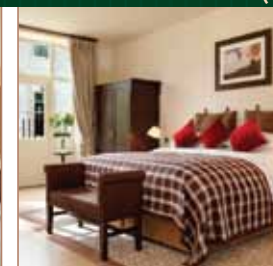

45-65 sq.m. | 450-700 sq.ft.

## INCENTIVE IDEAS

1. **SPA SOLIS EXPERIENCE.** Spend from an hour to a full day. Time in Spa Solis is truly the way to relax, unwind, or simply indulge the senses with our unique Incentives Package. *Onsite.*
2. **TOUR OF SLIEVE LEAGUE** (the highest cliff face in Europe), **GLENCOLMCILLE AND ARDARA.** A full day tour to enjoy Donegal's majestic coastline and scenery. *Slieve League is 45 minutes drive from the hotel.*
3. A Walk/Hike through the **BLUE STACK MOUNTAINS.** From 2 hours to a full day experience. *Starts just 8 mins drive from the hotel.*
4. **DONEGAL BAY WATERBUS TOUR.** A unique way to learn about Donegal and its history. Tour lasts 75 minutes. *5 minutes drive from the hotel.*
5. **GOLF** on a championship links course. A superb quality course *just 10 minutes drive from the hotel.*
6. Go **FISHING.** Fish with a boat on Lough Eske. Full Day. *5 minute walk to Lake.*
7. Take a boat-trip to **ARRANMORE ISLAND** and enjoy whale and dolphin watching on your journey. Full Day. *The harbour is just over an hours drive from the hotel.*
8. **HORSE-RIDING** on sandy beaches for experienced horse riders and on woodland trails for beginners. *Just 30 minutes drive from the hotel.*
9. **CYCLING TOUR.** Starts from on-site and can last from 2 hours to a full day.
10. **ARCHERY, TREASURE HUNT, IT'S-A-KNOCK-OUT** and **CLAY PIGEON SHOOTING** activities *can be arranged onsite.*
11. Visit **GLENVEAGH NATIONAL PARK AND CASTLE**, Ireland's second largest National Park. A remote and hauntingly beautiful wilderness of rugged mountains and pristine lakes. A ranger-led hill walk is a must do during your visit. *1hr 30 minutes drive from the hotel.*
12. A visit to the **CITY OF DERRY**, European City of Culture 2013 including a walk around the city walls. *Derry is an hour's drive from the hotel.*



## AWARDS

- Luxury Country Hotel Award 2009 and 2010 | **World Luxury Hotel Awards**
- Castle Venue of the Year 2009 | **WeddingsOnline.com**
- Wedding Venue of the Year 2009 | **WeddingsOnline.com**
- World's Top New Hotels | **Condé Nast Traveller**

- Hotel of the Year | **My Guide Ireland**
- Taste of Donegal Award | **Donegal Food and Wine Festival**
- 2010 Top Castle Hotels | **US Travel Expert, Stephanie Abrams**
- Ireland's Best Spa Manager | **IBPA 2009**

## DINING

Every meal is a true delight at Lough Eske Castle. Though different in atmosphere and ambiance, the restaurants and bars celebrate the Irish love of food, drink, and good cheer.

### GALLERY BAR AND LOBBY LOUNGE

The Gallery Bar is the perfect place to meet for a pint of Guinness, glass of wine and an informal bite to eat from our Bistro menu.

Choose from a classic list of cocktails, aperitifs, after-dinner drinks and Irish coffees along with a wide variety of European and new world wines by the glass as well as a collection of over 60 fine whiskies.

Our comprehensive bistro menu uses the freshest and finest local produce available, so you can enjoy Donegal Bay oysters with a glass of champagne or our 100% Hereford beef burger and Solis triple cooked chips.

**OPEN: Sunday to Thursday 11am to 11.30pm | Friday and Saturday 11am to 12.30pm | Food served 12 Noon to 11pm daily.**

### CEDARS GRILL RESTAURANT



The new Cedars Grill combines easygoing elegance with a very contemporary sense of style.

Our Executive Chef has created a tantalizing menu that features fresh, local ingredients, masterfully prepared. There are organic selections, local beef, superb Irish stew and fresh catches from nearby Killybegs, Ireland's premier fishing port. And, of course, a wonderful collection of fine wines from around Europe and the world.

**OPEN: Breakfast - 7am to 11am | Dinner - 6pm to 10.30pm**

### OAK BAR

A cosy getaway with stone floors, heavy leather chairs, historical black and white photographs and a clubby oak ambiance. Here, you can join in a game of billiards, or simply sit back and enjoy the sounds of our traditional Irish music sessions whilst enjoying a pint of Guinness or one of our many fine whiskies.

**Available for private functions**



Lough Eske Castle, a Solis Hotel & Spa.  
*Where life takes you.*





### BALLROOM

A spacious, fully air-conditioned ballroom, flooded with natural daylight with floor to ceiling bay windows, which extend from the middle half of the room. The Ballroom subdivides into 3 separate, soundproof units or a combination. Ballroom II and III offers direct access to elevated gardens and an adjacent terrace overlooking the spectacular Blue Stack Mountains. The perfect venue for pre-dinner cocktails or coffee breaks. Decorated in natural tones this room can easily be transformed into a magical themed venue. In its entirety it is ideal for exhibitions, car launches and grand banquets.

640 sq.m. | 6,800 sq.ft.

### GLENCAR SUITE

Spacious fully air-conditioned designated boardroom with natural daylight and oak wood panelling throughout. Subdivides into two equal soundproof units (Glencar I and Glencar II) each with its own wall-mounted LCD screen. Although set as a designated boardroom, it can easily be transformed into a club-like suite for a private dinner.

112 sq.m. | 1,205 sq.ft.



## FUNCTION ROOMS

Whether it is a board meeting, corporate retreat or an executive round table event we have the facilities and capabilities to make this an occasion your clients will never forget.

### OAK BOARDROOM

Located in the lower basement of the Castle, this executive meeting room, presentation theatre or private dining room has a large open fireplace with an adjoining annex room ideal for pre-dinner cocktails or a break during a meeting.

51 sq.m. | 550 sq.ft.

ROOM Width, Height, Length, Area (in metres)	Theatre	Boardroom	Classroom	Banquet	Cocktail Reception
<b>BALLROOM</b> W:16   H:2.7-4   L: 40   A:640	400	100	250	280	350
<b>BALLROOM I AND BALLROOM III</b> Individually W:16   H:2.7-4   L: 13   A:208	120	50	80	80	100
<b>BALLROOM II</b> W:16   H:2.7-4   L: 14   A:224	130	30	85	100	120
<b>BALLROOM II AND BALLROOM III</b> Combined W:16   H:2.7-4   L: 27   A:432	230	75	120	160	220
<b>GLENCAR SUITE</b> W:7   H:2.6   L: 16   A:112	60	22	40	50	50
<b>GLENCAR I AND GLENCAR II</b> Individually W:7   H:2.6   L: 8   A:56	30	14	30	20	25
<b>OAK BOARDROOM</b> W:6   H:2.4   L: 8.5   A:51	--	14	--	30	14
<b>PRE-FUNCTION RECEPTION AREA</b> W:6   H:2.6   L: 50   A:300	--	--	--	--	150

Lough Eske Castle, a Solis Hotel & Spa  
DONEGAL TOWN



### ADDITIONAL FACILITIES AVAILABLE

Sound System · Video Equipment · AV equipment from laptops to LCD Screens · Lectern · Stage  
Teleconferencing · Technician · Wifi · Business Centre

## EXCLUSIVE USE

**LOUGH ESKE CASTLE** is available for exclusive hire. Whatever you are looking for: an important corporate event, a special party, a dream wedding or an informal get-together, exclusive use is the perfect way to ensure your party or event is private and dedicated especially for you and your clients. Take things at your own pace and really appreciate your surroundings with no interruptions.

## DELEGATE PACKAGES

Day and Residential Delegate Packages are available which embody our personality: attention to detail, exceptional reliability and the famous Donegal hospitality. Our professional and efficient Sales Team will look after your needs, be it a large scale conference or a company training seminar.

Contact us today at [meetings.lougheske@solishotels.com](mailto:meetings.lougheske@solishotels.com) with your request for a proposal.

Lough Eske Castle · Donegal Town · Co. Donegal · Ireland  
T +353 (0)74 97 25100 · F +353 (0)74 97 23762  
E [meetings.lougheske@solishotels.com](mailto:meetings.lougheske@solishotels.com)  
[www.solislougheskecastle.ie](http://www.solislougheskecastle.ie)



## GROUND FLOOR

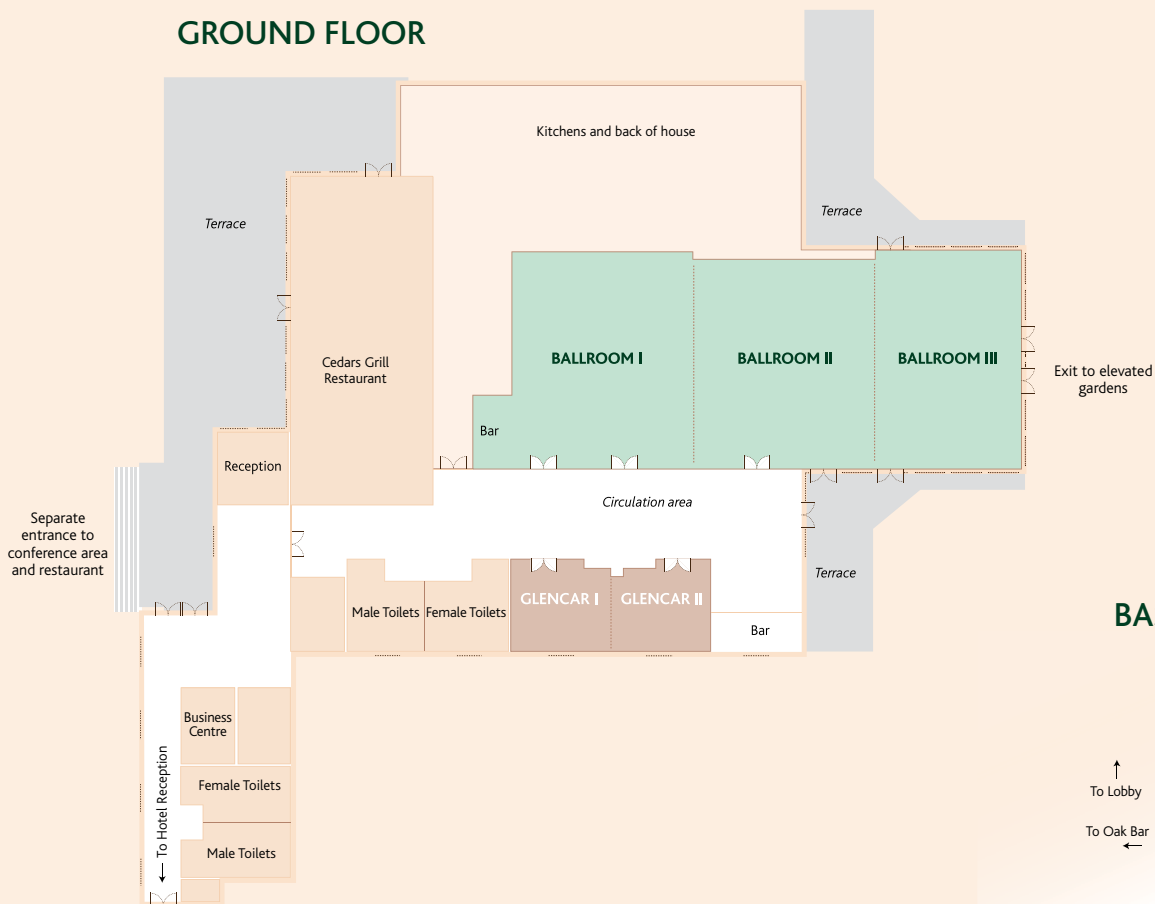

## BASEMENT LEVEL

